

Driver Details

Name
Date
Event / Track
Weather
Result

Chassis and Electrics

Chassis Kit ☐ Flex ☐
Car Weight g
Front Topdeck S2 2.0mm ☐ C/F 2.5mm ☐ C/F 3.0mm ☐
Rear Topdeck 2.5mm ☐ 3.0mm ☐
Sidepods S2 ☐ C/F ☐
Front Hex -0.75 ☐ 0 ☐ 0.75 ☐ 1.5 ☐
Rear Hex -0.75 ☐ 0 ☐ 0.75 ☐ 1.5 ☐
Bodyshell Thickness Rear Wing
E.S.C C/F Tray ☐ Brass Tray ☐
Servo
Receiver C/F Tray ☐ Brass Tray ☐
LiPo Front ☐ Middle ☐ Rear ☐

Track Conditions

Grip Level High ☐ Medium ☐ Low ☐
Type Tight ☐ Open ☐ Mixed ☐
Surface Clay ☐ Astro ☐ Grass ☐ Mixed ☐ Carpet ☐
Condition Smooth ☐ Bumpy ☐ Mixed ☐
Jumps Small ☐ Medium ☐ Large ☐ Mixed ☐

Wheels, Tyres and Inserts

Front Wheels Rear Wheels
Front Tyres Rear Tyres
Front Inserts Rear Inserts

Front Shocks Spring Shock Cap Sealed ☐
Oil.....cStlb/in Vented ☐ Aeration ☐
Piston..... Drilled ☐ Hole Size.....mm
Internal Limiters.....mm Kashima Body No ☐ Yes ☐
.....mm

Notes

CAT **EV**

Front Diff

Height High ☐ Mid ☐ Low ☐
Oil cSt 2 Gear ☐ 4 Gear ☐
Kit ☐ Alloy ☐ Carbon ☐

Rear Diff

Height High ☐ Mid ☐ Low ☐
Oil cSt 2 Gear ☐ 4 Gear ☐
Kit ☐ Alloy ☐ Carbon ☐

Motor and Gearing

Motor
Rotor Diameter
Timing
Spur Size
Pinion Size

Other settings

Rear Wing Gurney Height Wing Type
Front Wing Small ☐ Big ☐
Front Wing Gurney Height
Slipper 2Plate ☐ 3Plate ☐

Rear Shocks

Spring Shock Cap Sealed ☐
Oil.....cStlb/in Vented ☐ Aeration ☐
Piston..... Drilled ☐ Hole Size.....mm
Internal Limiters.....mm Kashima Body No ☐ Yes ☐
Shock Stand Off Spacingmm
.....mm

Front

Anti Roll Bar None ☐ 1.2 ☐ 1.4 ☐ 1.6 ☐ 1.8 ☐ 1.9 ☐ 2.0 ☐ 2.1 ☐

Ride Heightmm

Camber at Ride HeightDeg

ToeDeg
Yoke 8° ☐ 10° ☐ 12° ☐
Yoke Med ☐ Stiff ☐ Alloy ☐

Bumper Stiff ☐ Carbon ☐

Link Washersmm

Wishbone Med ☐ Stiff ☐ Carbon ☐

Wheelbase Short ☐ Long ☐

Bump Steer Washersmm

Hub Spacer High ☐ Low ☐

Driveshaft Kit ☐ Roche ☐

Pin Angle 8° ☐ 10° ☐ 12° ☐

Pin Width Narrow ☐ Mid ☐ Wide ☐

Hingepin Steel ☐ Ti ☐

Strap Alloy ☐ Brass ☐

Housing Kit ☐ Alloy ☐

Shock Mount C/F ☐ S2 ☐

Rear

Anti Roll Bar None ☐ 1.2 ☐ 1.3 ☐ 1.4 ☐ 1.6 ☐ 1.8 ☐ 1.9 ☐ 2.0 ☐ 2.1 ☐

Shock Mount C/F ☐ S2 ☐

Toe In
4° ☐ 3.5° ☐ 3° ☐ 2.5° ☐
2° ☐ 1.5° ☐ 1° ☐ 0.5° ☐

Ride Heightmm

Camber at Ride HeightDeg

Wheelbase Short ☐ Med ☐ Long ☐

Anti-squat 1° ☐ 2° ☐ 3° ☐ 4° ☐

Hub Washersmm

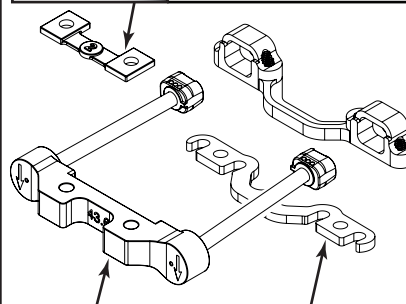

Hub Carrier Kit ☐ Alloy ☐

Brass insert Hi-Pin ☐ Low-Pin ☐

Rear Strap High Pin - Arrows up (U7977) ☐ Low Pin - Arrows down (Kit) ☐

Driveshaft U/J ☐ CVD ☐

Steel Washer Required

Link Washersmm

Housing Kit ☐ Alloy ☐

Gearbox Riser Yes ☐ No ☐

Wishbone Med ☐ Stiff ☐ Carbon ☐

Hingepin Steel ☐ Ti ☐

Link Mount Kit ☐ Alloy ☐